

How to create a LittleScribe classroom

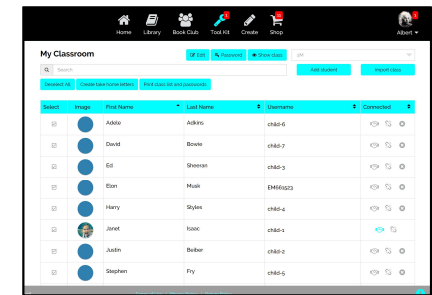
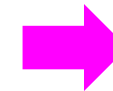
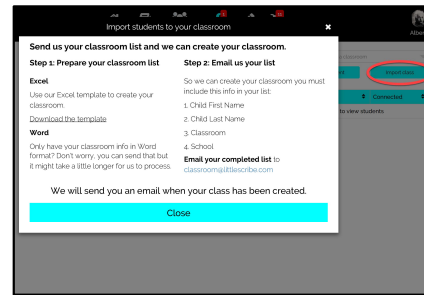
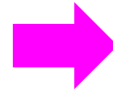
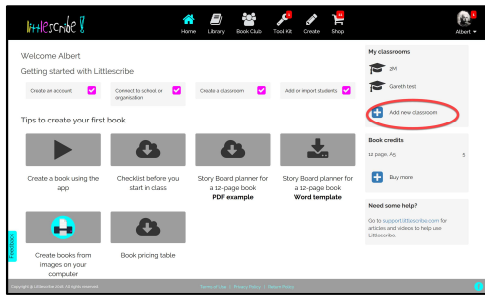

1. Log in to your LittleScribe teacher account, and click on 'Add a new classroom'.

2. Click on 'Import class' and a pop-up will instruct you to let us do the work for you! Send us a class list, either using the Excel template provided, or in Word if you prefer, and we will set up your classroom for you.

3. When your class is set up, your students can create and save their own book, share and read others' books, and their parents can connect to their account to celebrate in their writing progress.

Teaching Tips:

- ✓ When your classroom is set up, you can easily add students to your LittleScribe class if someone new joins you.
- ✓ You can access your students' usernames and passwords from the LittleScribe platform, and you can create a class library for them to share their writing.
- ✓ Once your classroom is set up, you can connect parents to their child's work, providing an essential link between home and school. A homework task could be for students to share their work with someone at home.